

Required King & Jack Studs at End of an Opening

Opening Width	24" O.C. Spacing		16" O.C. Spacing	
	No. of Jacks	No. of Kings	No. of Jacks	No. of Kings
Up to 3'-6"	1	1	1	1
>3'-6" to 5'-0"	1	2	1	2
>5'-0" to 5'-6"	1	2	2	2
>5'-6" to 8'-0"	1	2	2	2
>8'-0" to 10'-6"	2	2	2	3
>10'-6" to 12'-0"	2	2	3	3
>12'-0" to 13'-0"	2	3	3	3
>13'-0" to 14'-0"	2	3	3	4
>14'-0" to 16'-0"	2	3	3	4
>16'-0" to 18'-0"	3	3	4	4

Notes
1) Jack and king stud notes on the plan supercede this table if present

1/25 TYP. FRAMED OPENING HEADER DETAIL
SCALE: 1/2"=1'-0"

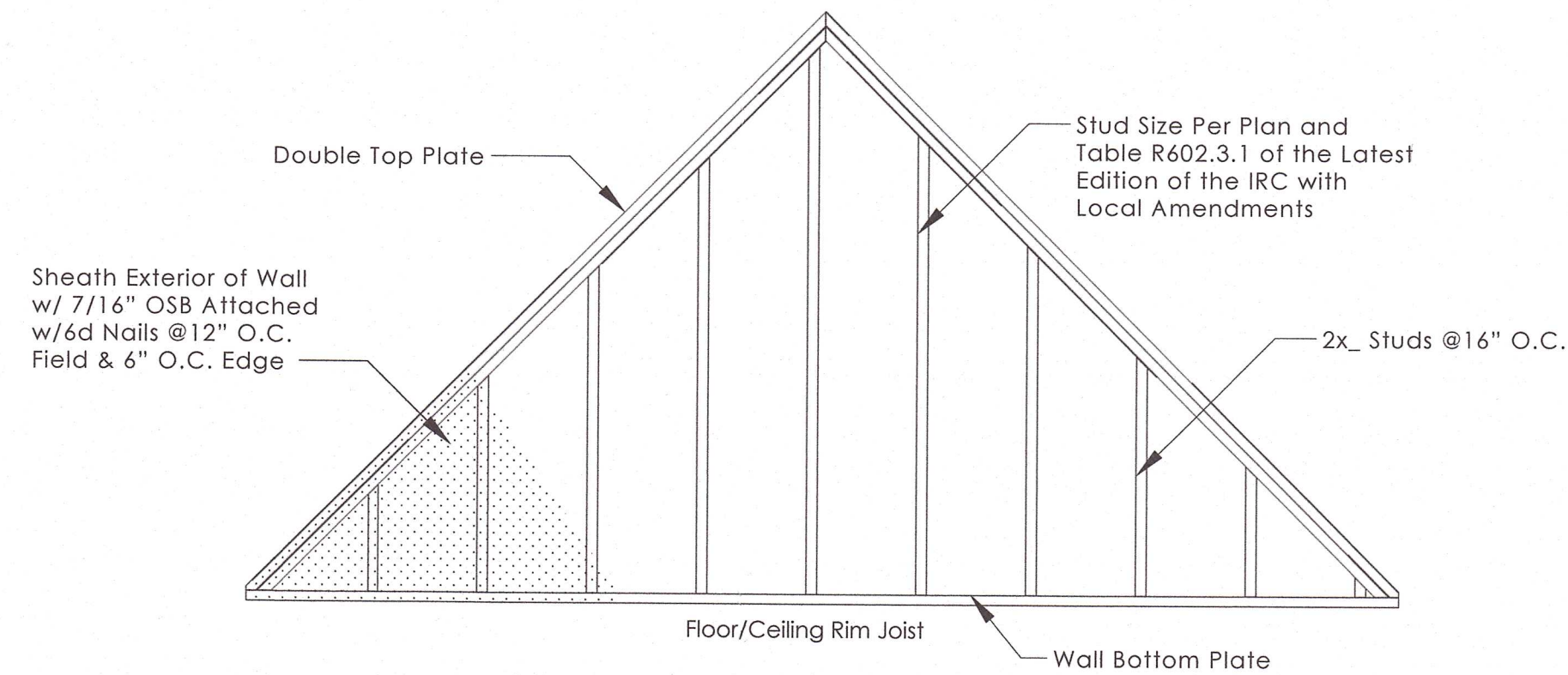

2/25 TYP. GABLE END WALL
SCALE: 1/2"=1'-0"

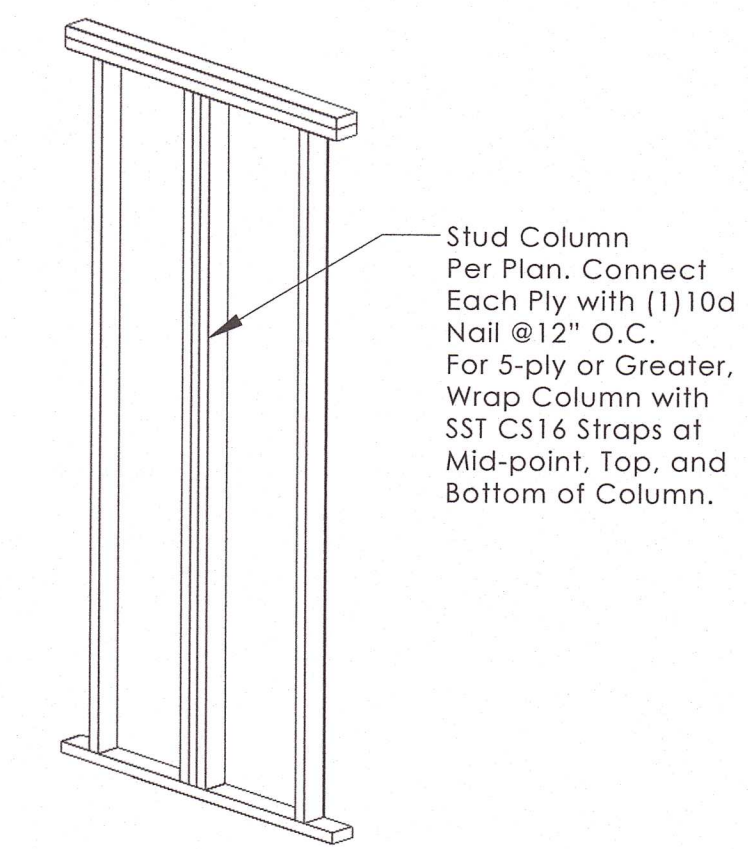

3/25 TYP. STUD COLUMN
SCALE: 1/2"=1'-0"

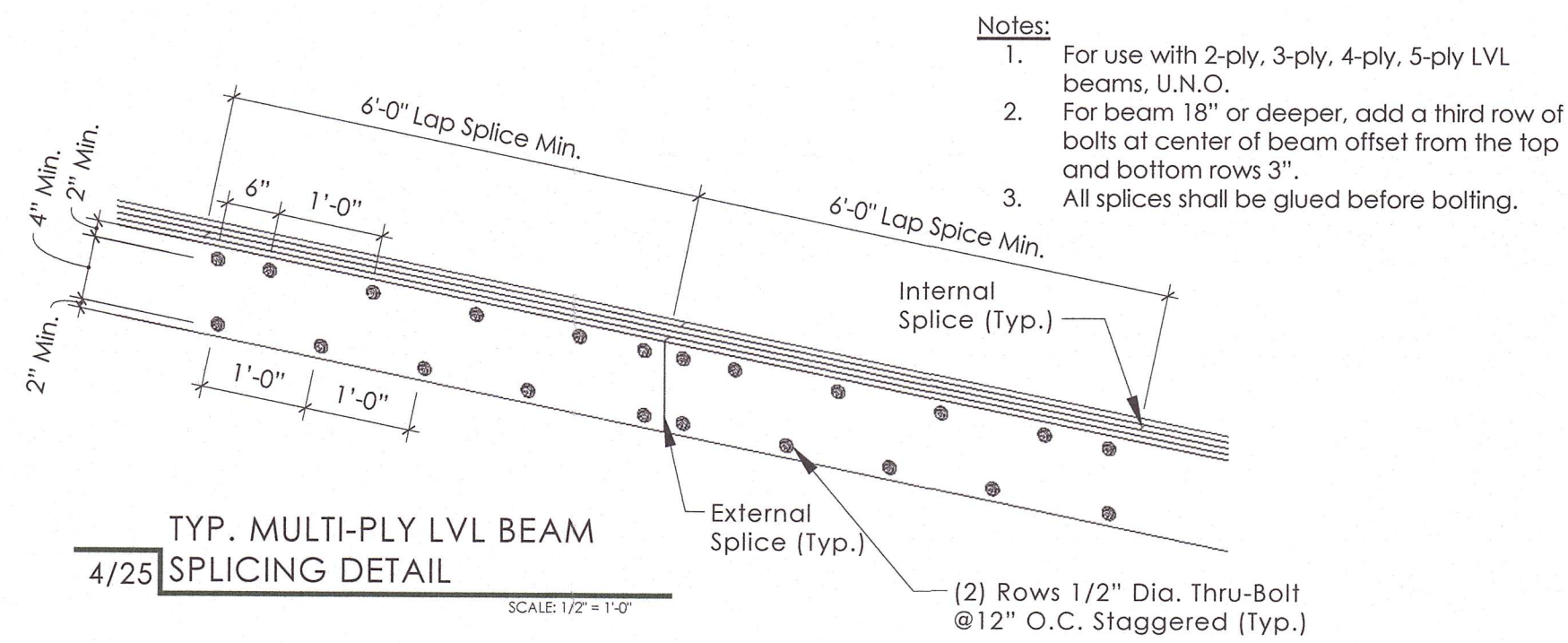

4/25 TYP. MULTI-PLY LVL BEAM SPlicing DETAIL
SCALE: 1/2"=1'-0"

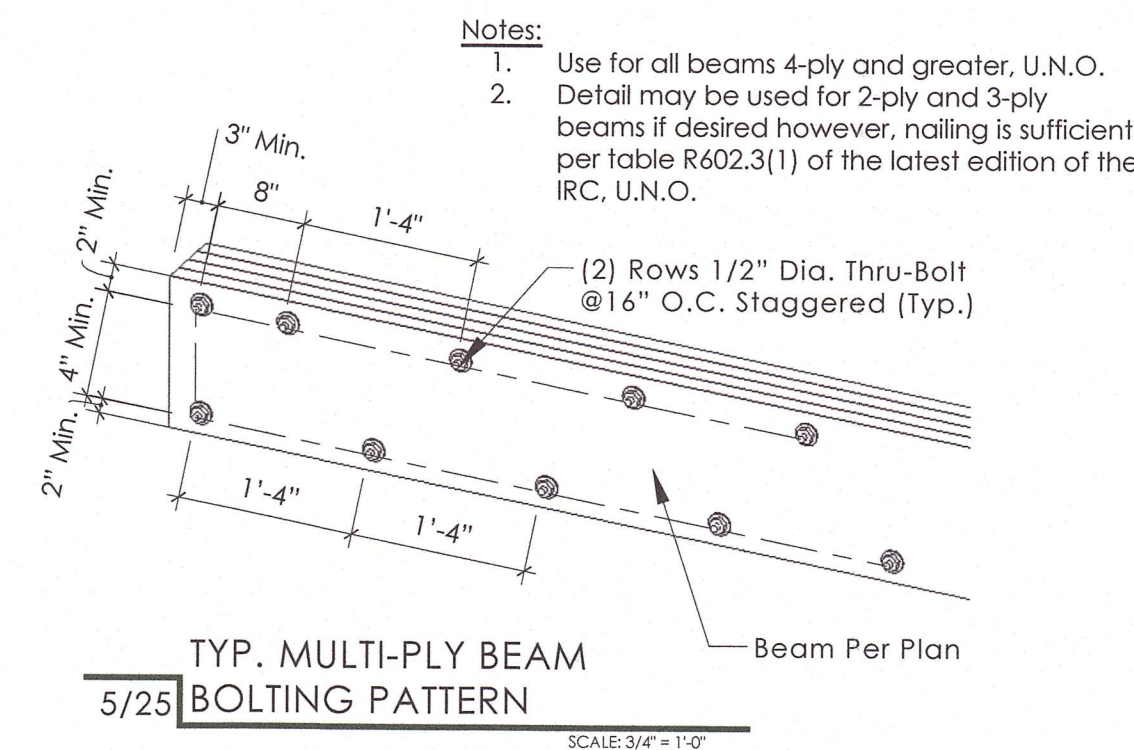

5/25 TYP. MULTI-PLY BEAM BOLTING PATTERN
SCALE: 3/4"=1'-0"

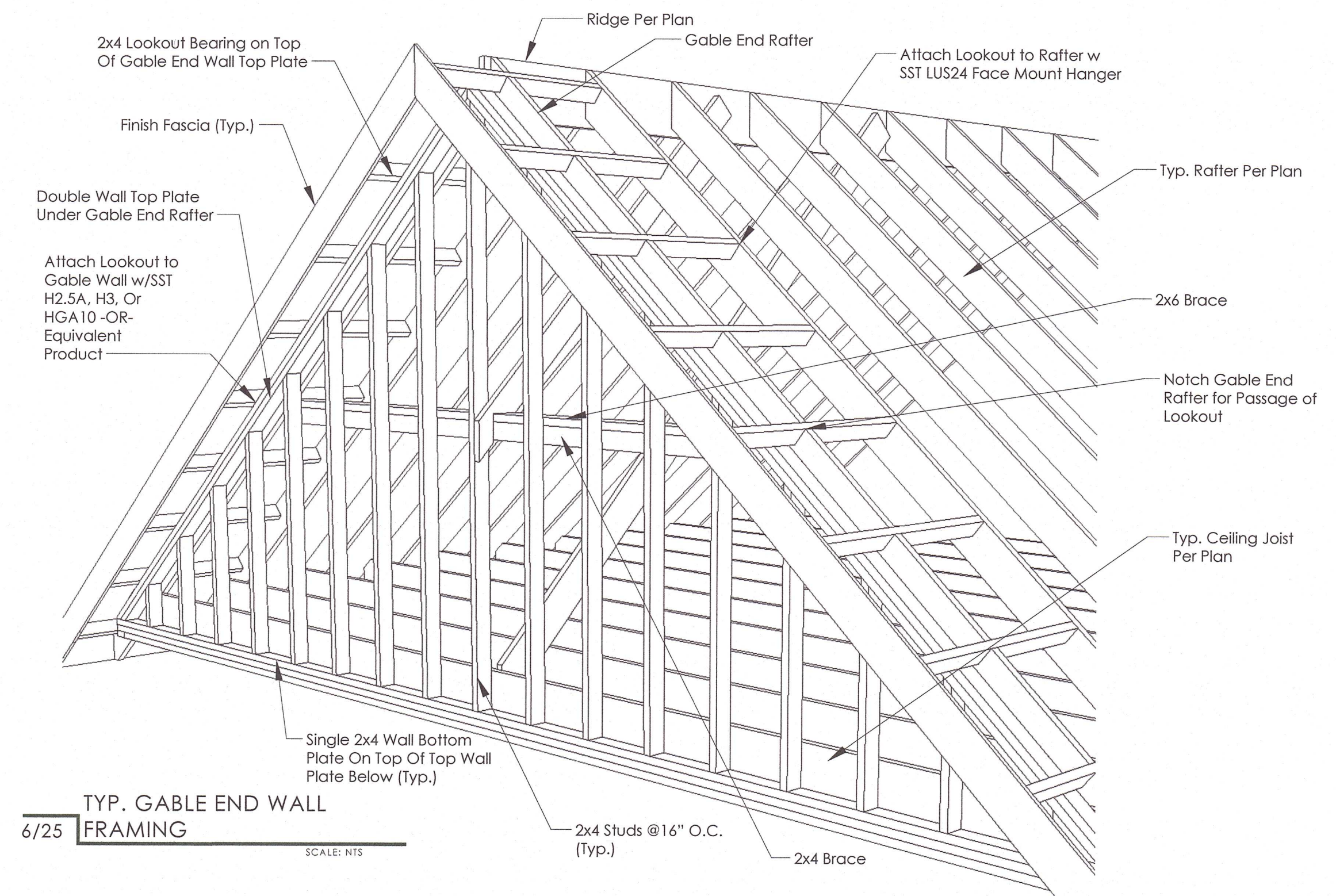

6/25 TYP. GABLE END WALL FRAMING
SCALE: NTS

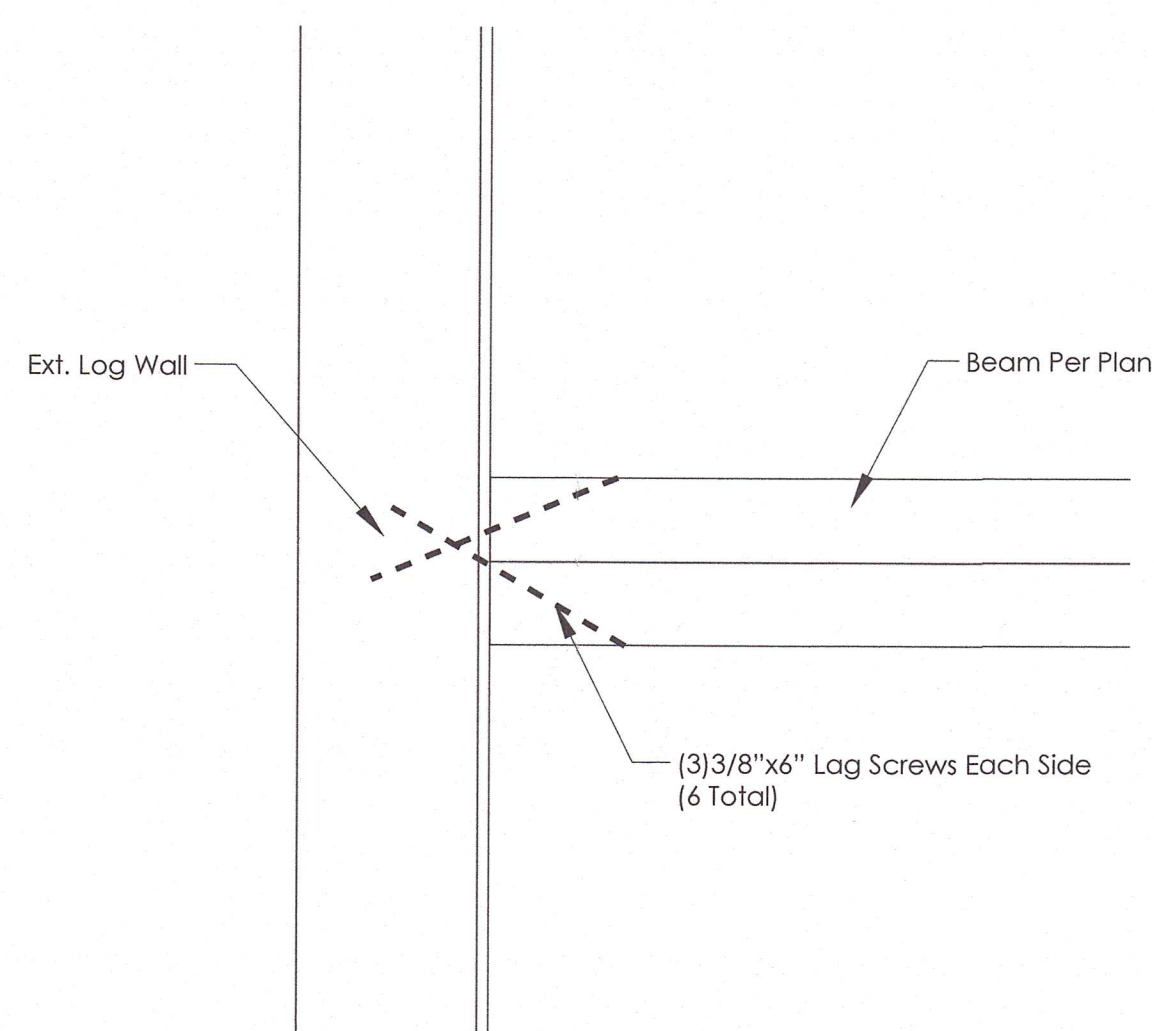

7/25 WALL TIE/WALL CONNECTION
SCALE: 3"=1'-0"

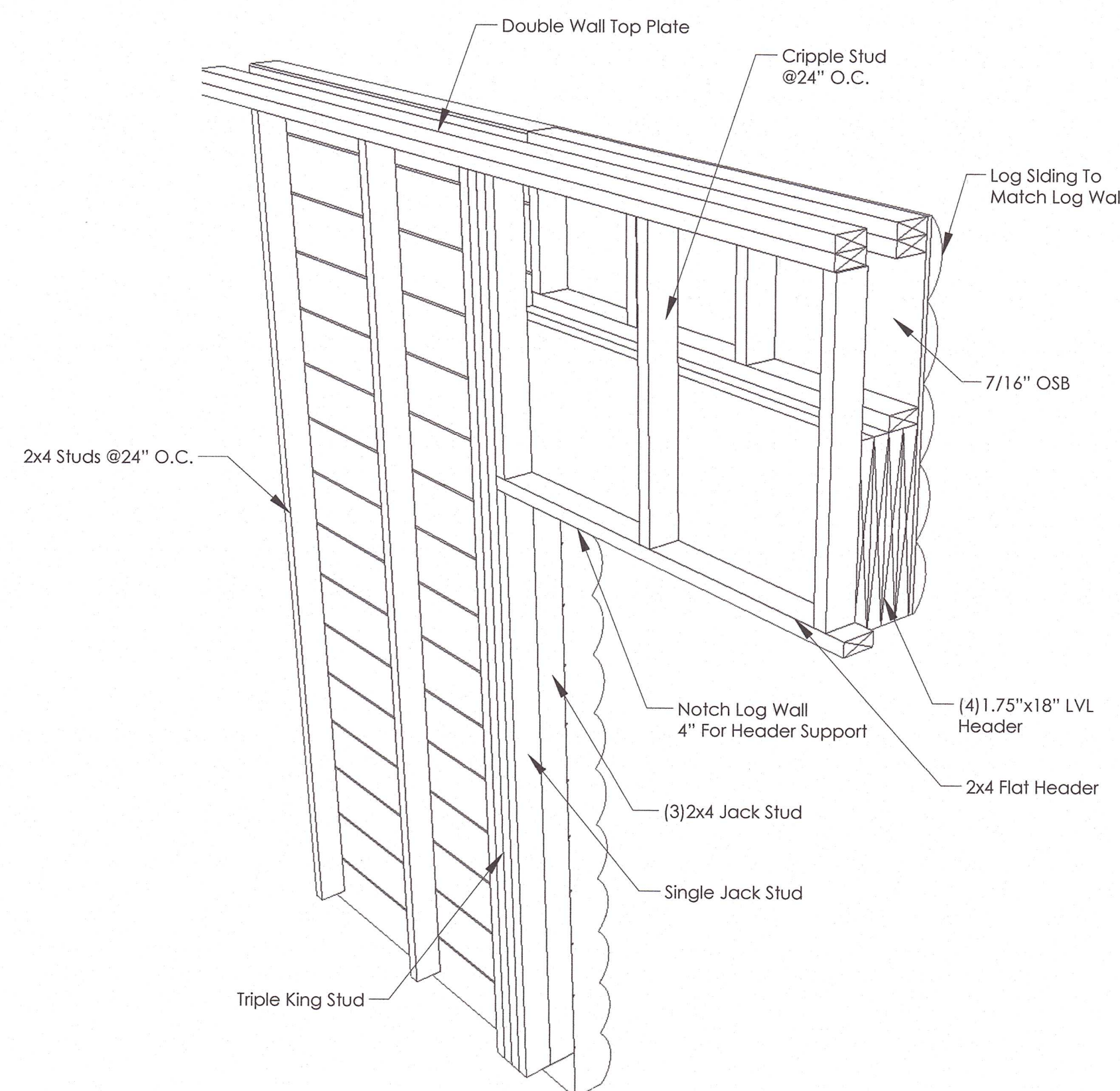

8/25 DECK DOOR HEADER
SCALE: NTS



Structural Members Only

Project No. 23014
Drawn By B.A.A.
Publish Date Feb 14, 2023

Sheet No.