

Other Cemetery Number

NC OSA Reviewer: Date:

State Site Number: 31

Revisit? ☐

**NORTH CAROLINA ARCHAEOLOGICAL SITE FORM**  
**Citizen Cemetery Site Form**  
**Office of State Archaeology/Division of Archives & History**

*Please fill out as much of the information as possible and attach a map showing the location of the site. A North Carolina state site number will be assigned to your site and the location added to our records based on the information you provide.*

1. STATE SITE NUMBER [FOR OFFICE USE]:

2. OTHER CEMETERY NUMBER(S):

3. IS THIS A REVISIT SUBMISSION?

☐ YES ☐ NO**GENERAL IDENTITY, LOCATION, AND OWNERSHIP INFORMATION**

4. CEMETERY NAME(S): Chatham Friends Meeting

5. COUNTY: Alamance

6. CEMETERY ADDRESS OR LOCATION DESCRIPTION: "4507 GREENHILL RD  
SNOW CAMP, NC 27349"

7. CEMETERY OWNER AND ADDRESS (if different than above):

8. NAME AND CONTACT INFO OF INDIVIDUAL(S) OR INSTITUTION(S) WHO HOLD MORE INFORMATION ABOUT THIS CEMETERY:

8A. WHAT INFO DO THEY HAVE?

9. ACCESS TO THIS CEMETERY IS:

☐ RESTRICTED☒ UNRESTRICTED

9A. EXPLAIN:

**PRIMARY RECORDER INFORMATION**

10. FIRST AND LAST NAME: Foster Emmert

11. ORGANIZATION: Alamance County GIS

12. ADDRESS: 124 West Elm Street, Graham, NC, 27253

13. PHONE NUMBER: 336-570-4113 or Foster.Emmert@alamancecountync.gov

14. RECORDERS RELATIONSHIP TO CEMETERY: ☐ PROPERTY OWNER ☐ DESCENDANT ☒ RESEARCHER  
☒ GENERAL INTEREST**MAP DATA**

*Please attach a map showing location of cemetery. Contact NC OSA staff for help. Please provide coordinates (like Latitude and Longitude) so the site is recorded accurately on the landscape. A plan view sketch of cemetery is encouraged.*

15. LATITUDE: LONGITUDE: OTHER COORDINATES:

15A. SOURCE (GOOGLE MAPS, GPS, ETC.): 79.3100735°W 35.8774162°N calculated with GIS

**CEMETERY DESCRIPTION****16. CEMETERY TYPE:**☐ PUBLIC☐ MUNICIPAL ☐ STATE ☐ FEDERAL ☐ MILITARY ☐ TRIBAL☒ PRIVATE☐ FAMILY ☒ CHURCH (REPORT NAME/DENOMINATION) ☐ FRATERNAL/ORGANIZATION  
(REPORT NAME) ☐ OTHER☐ UNKNOWN/ABANDONED**16A. DETAILS OR EXPLANATIONS:****17. CURRENT STATUS:**☒ WELL MAINTAINED AND PRESERVED☐ marginally maintained☐ NOT MAINTAINED☐ OVERGROWN, BUT EASILY IDENTIFIABLE☐ OVERGROWN, NOT EASILY IDENTIFIABLE☐ NOT IDENTIFIABLE AS A BURIAL SITE (OR KNOWN TO EXIST BY ORAL TRADITION)**CEMETERY FEATURES INFORMATION***Please complete the attached Marker Description Form and submit with application.*

18. NUMBER OF MARKED GRAVES: 19. POSSIBLE NUMBER OF UNMARKED GRAVES:

**20. KNOWN YEARS OR PERIOD OF USE:****21. DATE OF EARLIEST MARKER:** 1909**22. DATE OF MOST RECENT MARKER:****23. BURIALS IN THIS CEMETERY ARE:**☒ MARKED WITH GRAVESTONES, MONUMENTS, WALLS, FENCES, CRYPTS, MAUSOLEUMS, OR  
OTHER VISIBLE FUNERARY ARCHITECTURE☐ UNMARKED ONLY, DEPRESSIONS PRESENT OR POSSIBLY MARKED BY UNINSCRIBED FIELD  
STONES, PLANTS, SHELLS, OR ARTIFACTS☐ BOTH MARKED AND UNMARKED**24. ARE THERE UNUSUAL OR SIGNIFICANT MARKERS PRESENT?**☐ YES ☐ NO**24A. IF YES, PLEASE DESCRIBE:****25. TO WHICH CULTURE WERE PEOPLE BURIED IN THIS CEMETERY MOST OFTEN AFFILIATED? (CHECK ALL  
THAT APPLY):**☐ AFRICAN AMERICAN ☐ EURO AMERICAN ☐ NATIVE AMERICAN ☐ UNKNOWN☐ OTHER (DESCRIBE):**25A. HOW HAS THE ABOVE BEEN DETERMINED (EX. DOCUMENTS, ARTIFACTS, ORAL TRADITION)?**

Other Cemetery Number:

NC OSA STAFF USE: State Site Number:31

26. ARE ARTIFACT PRESENT ON OR NEAR BURIALS OR WITHIN THE CEMETERY'S GROUNDS?

☐ YES ☐ NO ☐ UNKNOWN

26A. DESCRIBE, INCLUDING LOCATION OR PROXIMITY TO OTHER CEMETERY ELEMENTS:

27. IS THE CEMETERY ENCLOSED?

☐ YES ☒ NO

27A. TYPE AND MATERIAL OF ENCLOSURE:

☐ FENCE (MATERIAL TYPE):

☐ HEDGE (WHICH SPECIES):

☐ OTHER (EXPLAIN):

28. ARE THERE ANY OTHER NOTABLE FEATURES OR STRUCTURES WITHIN THIS CEMETERY?

☐ YES ☐ NO

28A. DESCRIBE:

### THREATS

29. ARE THERE ACTIVITIES OR NATURAL FORCES THAT THREATEN THE STABILITY OF THE SITE OR MIGHT IMPACT THE BURIALS? (CHECK ALL THAT APPLY.)

☐ DEVELOPMENT OR CONSTRUCTION ACTIVITIES ☐ VANDALISM ☐ ANIMALS/GRAZING

☐ FARMING OPERATIONS ☐ INDUSTRIAL OPERATIONS ☐ EROSION ☐ NEGLIGENCE ☒ NONE KNOWN

☐ OTHER (DESCRIBE):

29A. EXPLAIN:

### HISTORICAL SIGNIFICANCE OF THE CEMETERY OR PERTINENT INFORMATION

EXPLAIN HERE:

Please email or mail completed form, map and any photographic attachments to:

Melissa Timo  
Historic Cemetery Specialist  
Office of State Archaeology  
4619 Mail Service Center  
Raleigh, NC 27699-4619  
[melissa.timo@dncr.nc.gov](mailto:melissa.timo@dncr.nc.gov) (919-814-6562)

*Other Cemetery Number:*

*NC OSA STAFF USE: State Site Number:31*

<b>Name(s) on marker</b>	<b>Birth date</b>	<b>Death Date</b>	<b>Marker Type</b>	<b>Marker Material</b>	<b>Condition of marker</b>	<b>Inscription</b>

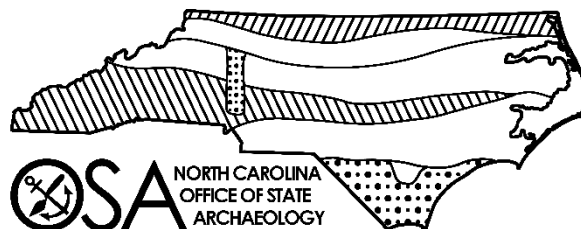

## Cemetery Site File Form Submission Checklist

### **\*Required\***

- ☐ Completed form
- ☐ Site location coordinates
- ☐ Map

### **Strongly encouraged**

- ☐ Planview map of cemetery layout
- ☐ Marker description form
- ☐ Photographs

### **Warmly welcomed**

- ☐ Site histories
- ☐ Genealogical narratives

### **Need help?**

Refer to the North Carolina Citizen Site Form Instructions for instructions and tips.

### **Still can't find your answer?**

Contact OSA! [Melissa.timo@ncdcr.gov](mailto:Melissa.timo@ncdcr.gov) or 919-814-6562





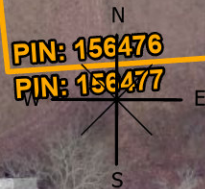

PIN: 156476  
PIN: 156477

GREENHILL RD

PIN: 156477

PIN: 156467

PIN: 156477  
PIN: 156467

4507

PIN: 156465  
PIN: 156477

PIN: 156467  
PIN: 156465

PIN: 156465

PIN: 156477

- Address
- Major Roads
- Streets
- Alamance Parcels

1 in = 67 feet

0

0.01

0.03

**DISCLAIMER:**  
The datasets and maps available are not survey grade or a legal document. They are a best approximation of what is on the ground, but do contain errors. The data comes from various sources nationally, the state of North Carolina, and here in Alamance County. Alamance County will not be held responsible for the misuse, misrepresentation, or misinterpretation of the data or maps. These maps and data are a service provided for the benefit for Alamance County citizens. We constantly strive to improve the quality and expand the amount of data and maps available.

ALAMANCE COUNTY shall assume no liability for any errors, omissions, or inaccuracies in the information provided regardless of how caused; or any decision made or action taken or not taken by user in reliance upon any information or data furnished hereunder. The user knowingly waives any and all claims for damages against any and all of the entities comprising the Alamance County GIS System that may arise from the mapping data.

Date: 7/2/2025





PIN: 156467  
PIN: 156465

• Address

— Major Roads

— Streets

□ Alamance Parcels

1 in = 28 feet

0

0.01

0.01 Miles

**DISCLAIMER:**

The datasets and maps available are not survey grade or a legal document. They are a best approximation of what is on the ground, but do contain errors. The data comes from various sources nationally, the state of North Carolina, and here in Alamance County. Alamance County will not be held responsible for the misuse, misrepresentation, or misinterpretation of the data or maps. These maps and data are a service provided for the benefit for Alamance County citizens. We constantly strive to improve the quality and expand the amount of data and maps available.

ALAMANCE COUNTY shall assume no liability for any errors, omissions, or inaccuracies in the information provided regardless of how caused; or any decision made or action taken or not taken by user in reliance upon any information or data furnished hereunder. The user knowingly waives any and all claims for damages against any and all of the entities comprising the Alamance County GIS System that may arise from the mapping data.

Date: 7/2/2025